



BUILD GREEN THE FUTURE IS NOW



Build **GREEN** the future is NOW

Sustainable. Durable. Environmentally Friendly.

Contents

Introduction

Company Background	03
Awards & Certificates	07
Exhibition 2015 - 2010	15
Social Responsibility	27
Corporate Info	33
Technology	35

Product Category

Architectural Product	39
Landscape Product	43
IBS Product	51

Complete Projects

Istana Project	57
Commercial Project	61
Residence Project	67
IBS Wall Solution Project	77
On-Going Project	79

Project List

2022 - 2016 : Completed Projects	85
2015 - 2000 : Completed Projects	87

Contact Us

1

Introduction



Company Background

CSL Technologies (M) Sdn Bhd has today grown to become one of the leading precast Lightweight Reinforced Concrete (LRC) architectural products manufacturer industries in Malaysia. The company has carved a solid reputation as an innovative, quality conscious designer with strong creative capabilities. LRC product has obtained "Green Label" from Singapore and recognized by international and local

architects association as well. LRC has made its mark by delivering high quality & safety products in conducive living environments showcased through each and every one of its home design in Malaysia and oversea market. The precast LRC architectural decorative products are supported by Developers, Architects, Designers and Contractors.

Product Carbon Footprint Award 2014





Sayong Bridge

Vision

- To achieve Best-In-Class sustainable city development in Malaysia and region.
- Achieving Quality Safety and Environment Friendly product.
- Enhancing Customer Satisfaction & Maintaining Customer Loyalty.
- Improving Cost Efficiency and Productivity.

Mission

We aim to provide superior customer service and satisfy on climate change by collaborating with people industries and governments to encourage customer needs through a culture of excellence to enhance shareholders' value. At the same time, to create lasting impact and achieve sustainable urbanization.

- Conserving biodiversity in the urban environment.
- Setting new sustainability standard for urban development.
- Leading green lifestyles, educating and empowering communities.



SP Setia HQ



Residential Bungalow



Istana Putrajaya



Johor Premium Outlets

Awards & Certificate

MALAYSIAN BRAND AWARD CEREMONY 2013





ECO-B AWARD CEREMONY 2013

SIRIM AWARD CEREMONY 2013



SME AWARD 2010





ARCHIDEX 2010



AWARDS



CERTIFICATE





Exhibition 2015 - 2010



ARCHIDEX 2015



IGEM 2014



BRUNEI ENERGY EXHIBITION 2014



IGEM 2013



ARCHIDEX 2013





ECO B 2013



SMIDEX 2012



IGEM 2012



SMIDEX 2011





BTS, KUCHING 2011



MYFREN 2010



Social Responsibility



**PUSAT PENJAGAAN KANAK-KANAK
CACAT TAMAN MEGAH 2015**





NEPAL EARTHQUAKE, 2015



BEAUTIFUL GATE FOUNDATION
AT PETALING JAYA 2014



**ZANGDOK PALRI AT VIJRAVARAHI
MONASTERY, NEPAL 2013**

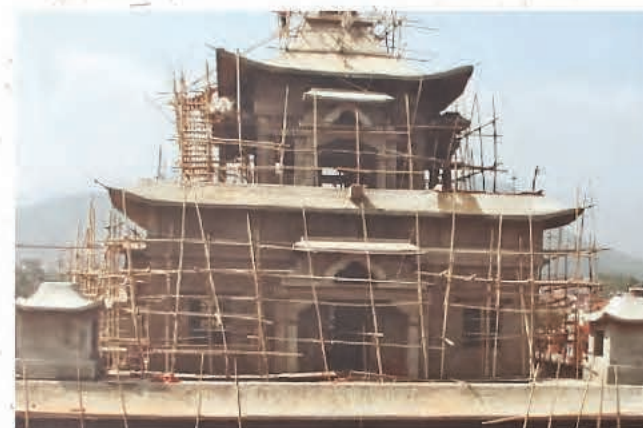

**ACUPUNCTURE MEDICATION
AT KAMPUNG JAWA OFFICE 2012**



Corporate Information

Manufacturer : CSL Technologies (M) Sdn Bhd (429166 – A)

Company

Address : Lot 7705, Batu 11 3/4, Jalan Kuari Sungai Long.
43100 Hulu Langat,
Selangor Darul Ehsan,
Malaysia.

Telephone No : 012- 657 0113

Whatsapp No : 012- 657 0113

Email Address : lrcinside@lrc.com.my
marketing@lrc.com.my

Website : www.lrc.com.my

Main Activity : To Design, Carving, Moulding and
Fabricate of Precast Lightweight
Reinforced Concrete (LRC)
Architectural and Wall Solution Products.

Technology

LRC inside represents revolutionary technology and processes that transform recycled material into green product for building constructions, so called Lightweight Reinforced Concrete (LRC). We are proud to be noted as an organization that is in constant pursuit of engineering excellence, speed up delivery, high quality products, cost effectiveness, dependable services and sustainable environmental friendly to customers with the obtain of "green label" endorsed by Singapore Environment Council (SEC) for Singapore green labeling scheme.

The innovative technology 'VCC', vacuum compaction concrete, our production speed is much faster as comparing to the conventional type. VCC Technology demould within 15 minutes and this enable the reuse of existing mould back into production and thus reducing more than 70% in moulding cost. Comparison between a conventional mould and a VCC mould is 1 conventional mould could produce 1 piece per day while demoulding time is 12 hours, comparing to the LRC demoulding time

which is 15 minutes, thus producing forty pieces per day, which is forty time faster than the conventional method. This is very significant in terms of using optimum labor to produce better quality products at a much faster pace, hence achieving cost efficiency and productivity for the entire projects.

The Vacuum Compaction Concrete Technology (VCC) also reduces transportation cost by 50 per cent as it is able to complete its production schedule in a shorter period of time, and thereby also reducing Carbon Footprint by using lesser transportation trip. Since LRC architectural copings are much lighter with density 1000 – 1200 kg/m³, the installation speed is much faster and at the same time using lesser installers and heavy machinery is not require for the job e.g. mobile crane. LRC copings also minimize construction waste at site and this contributing to a much cleaner and safer construction work area.

LRC product is a high performance of Cement based composite product which gives Wall better performance with its Tongue and Groove design Block with 900-1000kg/m³ density and Panel with 1200-1300kg/m³ density for both internal and external usage. The eco-friendly material which consist of lightweight material and admixture with the natural manufacturing process gives the concrete an advantage of reduce in density. LRC products have achieved 2 and 4 hours fire rating test with its strength from 5 – 7mpa and it is noted to be IBS Wall Solution as well as Green Building Development for its advancing in Cost Saving, Lightweight and Speedy construction time as an overall.

FEATURES

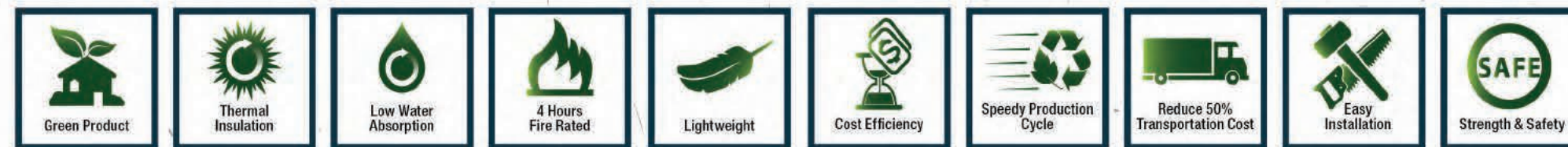

LRC PRODUCT CONTENT OF 3 RECYCLE MATERIALS

Newspaper Waste

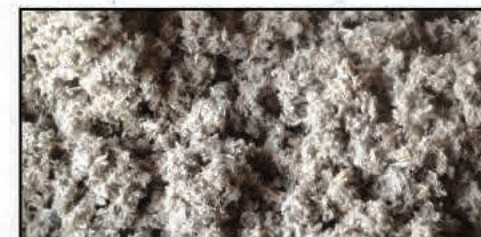

Cellulose Fiber

Polystyrene Waste



Polystyrene Powder

Coal Waste



Fly Ash

2

Product Category

Architectural Product



LRC Coping & Cornices

Sustainable. Durable. Environmentally Friendly.

The projecting cornice and others architectural elements are to bring your residential to another segment.



METHOD OF INSTALLATION

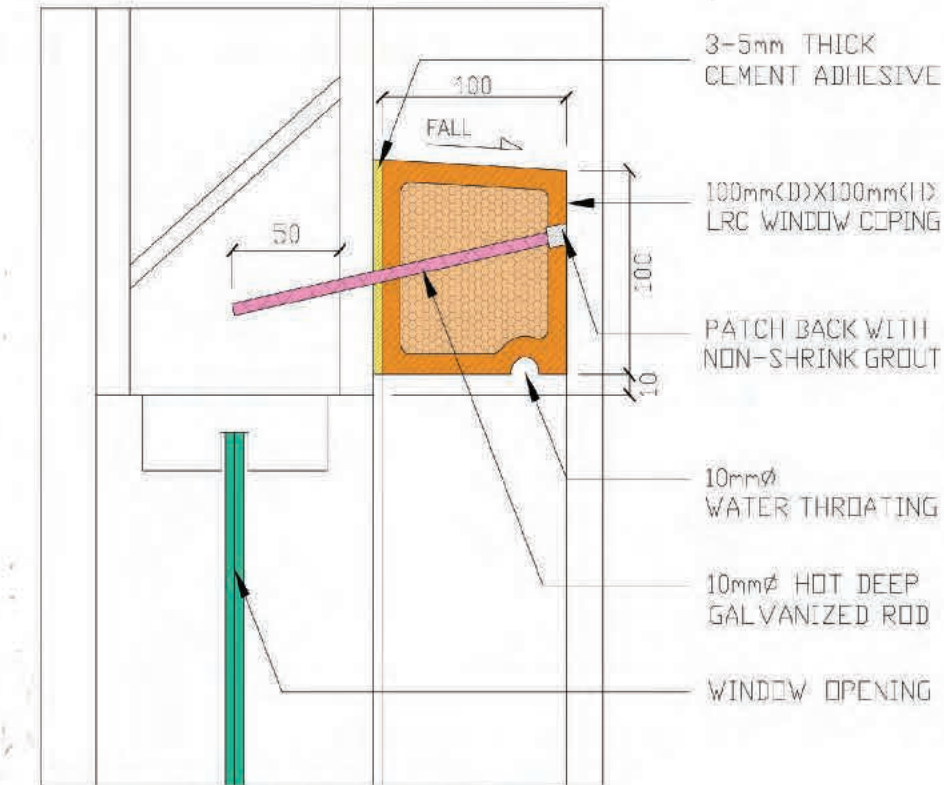

TYPICAL DETAIL

TYPICAL PROPERTIES

PROPERTY	VALUE
Dimension	100x100x1000mm
Shear Strength	1.5 - 2.5 Mpa
Compressive Strength	8 - 10 Mpa
Impact Strength	5 - 10 kj/m ²
Elastic Modules	10 - 20 Gpa
Dry Density	1200 - 1300kg/m ³
Fire Resistance	3 hours
Water Absorption	0.002ml/m ² /sec
M.O.R	15 Mpa
Freeze Thaw (50 cycles)	No deterioration



Column/Pillar

Columns are frequently used to support beams or arches on which the upper parts of walls and precast decorative column cladding use to enhance the Architectural or Heritage look.

In architecture, make your house or building more beautiful, Roman columns can offer the best solution. Roman columns, or pillars, were designed centuries ago and are still popular today because they are stylish and versatile.

Landscape Product

Fountain

Fountain is a piece of living work of art, a dynamic visual display that is never the same from one moment to the next. The soothing sounds of a waterfall help focus the mind, and bring the tranquility of a mountain stream into your home. It makes you relaxing like Mother Nature.



Planter Pot



Vase

Vases are defined as having a certain anatomy. Lowest is the foot, a distinguishable base to the piece.





Decorative Wall Panel

Wall panels are functional as well as decorative motif of art to external wall, providing a contemporary design and country feel with uniformity of appearance, along with some measure of durability or ease of irreplaceability.



Lantern

A lantern is a portable lighting device, or mounted light fixture used to illuminate broad areas. Lanterns may also be used for signaling, as 'torches', or general light sources outdoors (such as garden light). Low light level varieties are used for decoration. The "lantern" is also used more generically to mean a 'light source' or the enclosure for a light source.





Sculpture

For most sculptures a master is made, from which a mould is produced, in which the concrete is cast. A masterpiece is important to form a mould to the finished concrete product whereby the shape would not have any 'returns'.

Fiberglass mould were used to support the concreting process while a specific timing is required to have its perfect time to demould in perfect shape.



IBS Product

- Industrial Building System Product

LRC Eko-Panel Sustainable. Durable. Environmentally Friendly.



TYPICAL PROPERTIES

PROPERTY	VALUE
Dimension	100x600x3000 mm 125x600x3000 mm
Length Tolerance	+ / - 5 mm
Width Tolerance	+ / - 2 mm
Diagonal Strength	+ / - 2 mm
Weight - 100mm thick - 125mm thick	120 kg + / - kg/m ² 150 kg + / - kg/m ²
Dry Density	1000 - 1200 kg/m ³
Compressive Strength	5 Mpa
Thermal Resistance (m2) BS 874: Part 2: 1986	0.28 m ² K/W
Fire Test Temperature (SIRIM)	70°C / 1000°C (Ext./ Internal)
Surface Alkalinity	pH 7 - 10
Fire Rated Partition	130 minutes BS 476: Part 22
Water Absorption	<10% Test of 24 hours
Installation Speed	30 m ² / day
Anchorage Load	100 kg
Sound Insulation - 100mm thick - 125mm thick	40 dB 45 dB

METHODS OF INSTALLATION

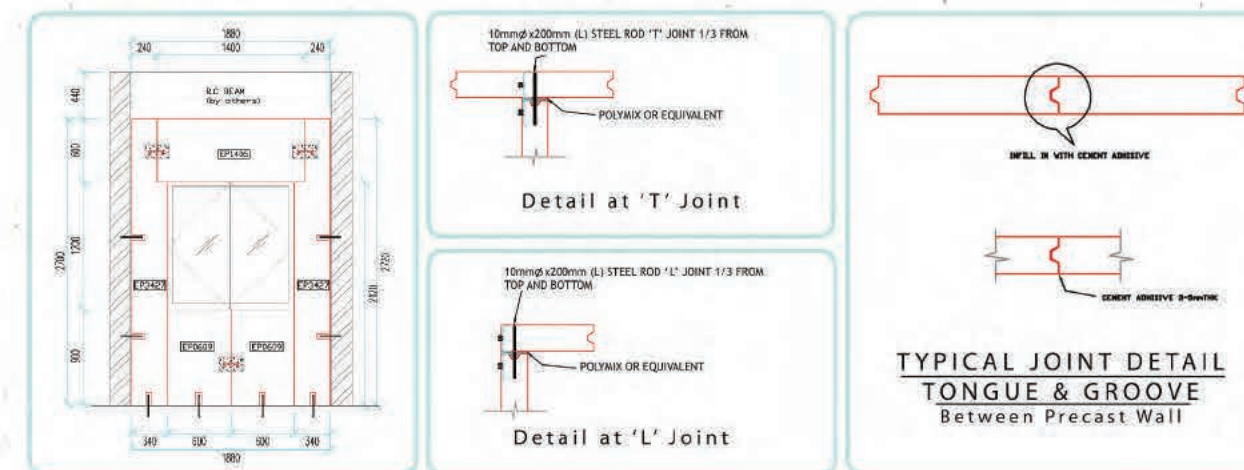



LRC Eko-Block

Sustainable. Durable. Environmentally Friendly.



T Shape Block

**Tongue & Groove
Design Block**



LRC EKO-Block is a new generation of lightweight concrete product made from environmental friendly material for building industry today. It is made using combines the extensive knowledge of sustainable 'Green' product with advanced process engineering skills on the mould design to produce various size of block. It is content more than 20% recycled material or environmental friendly material.

L Shape Block



In year 2011, LRC EKO-Block is endorsed by the 'Green Label' from Singapore Environment Council (SEC) for Green Labeling Scheme (SGLS) a certification given to environment-friendly products that also recognized by international Global Eco-Labeling Network (GEN). It comes with outstanding specification, as well as design mix. Its specification has met the maximum safety standards and fire resistance that has long reliable life cycle proven by SIRIM.

EKO-Block product mainly recommended for wall finish is engineered to resolve problem such as fire resistant, thermal insulation, sound insulation, water resistant, termite damage and exposure to toxic chemical from formaldehyde. It can be easily installed and finished by typical wall finish. It is suitable for Commercial & Residential building, especially for IBS or Green Buildings design to score points.

- **For external & internal wall**
- **Clean, neat & safety at site**
- **Low wastage**
- **Fast & easy installation**
- **Speedy construction**

- **Finishing in skim coat and cement render**
- **Excellent sound & thermal insulation**
- **Extremely fire resistant**
- **Low water absorption**
- **Cost saving**

METHODS OF INSTALLATION

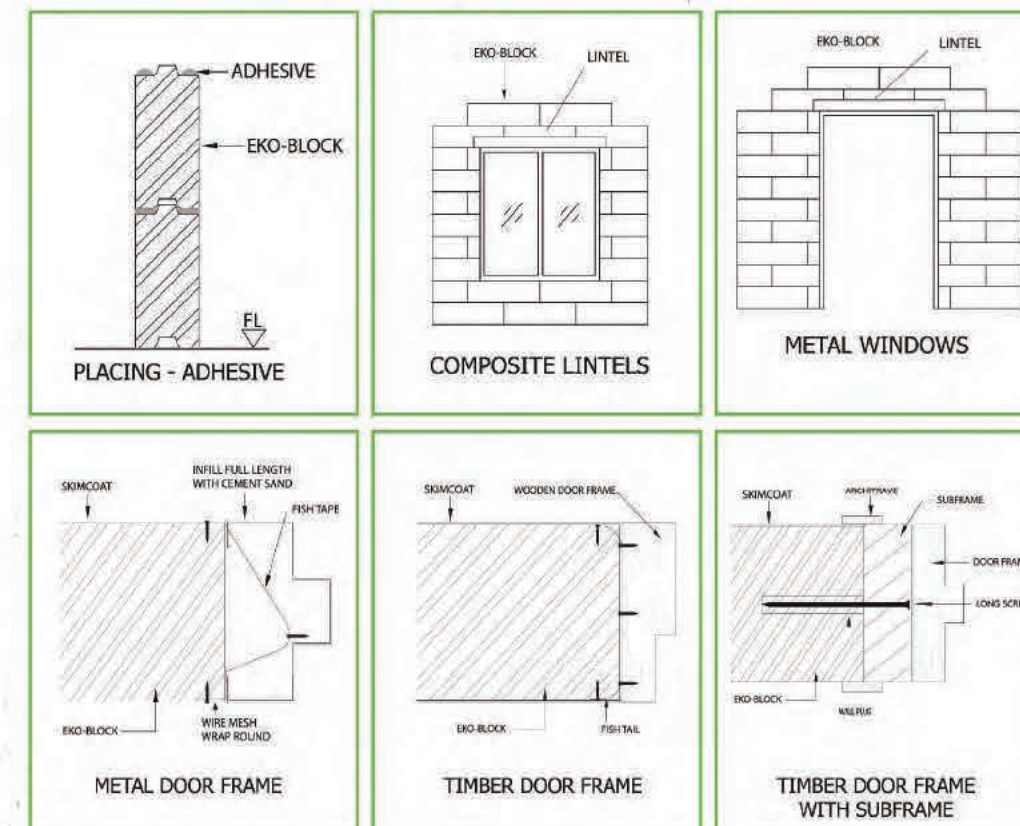

TYPICAL PROPERTIES

PROPERTY	VALUE
Dimension	100x208x600 mm 125x208x600 mm
Bending	2 - 4 Mpa
Shear Strength	1.5 - 2.5 Mpa
Compressive Strength	3 - 5 Mpa
Impact Strength	5 - 10 kj/m ²
Elastic Modules	10 - 20 Gpa
Thermal Resistance(m ²)	0.3m ² K/W
Dry Density	900 - 1000 kg/m ³
Weight	11.5 kg - 12.5 kg
Fire Resistance	100mm - 2 hours 125mm - 4 hours
Water Absorption	31.1 g/m ² sec ^{0.5}
Freeze Thaw (50 cycles)	No deterioration
Sound Insulation	
- 100mm thick	43 dB
- 125mm thick	50 dB

3

Project Showcase

Istana Project

ISTANA ARAU, PERLIS



ISTANA DARUL EHSAN, PUTRAJAYA





ISTANA PERAK GALLERY

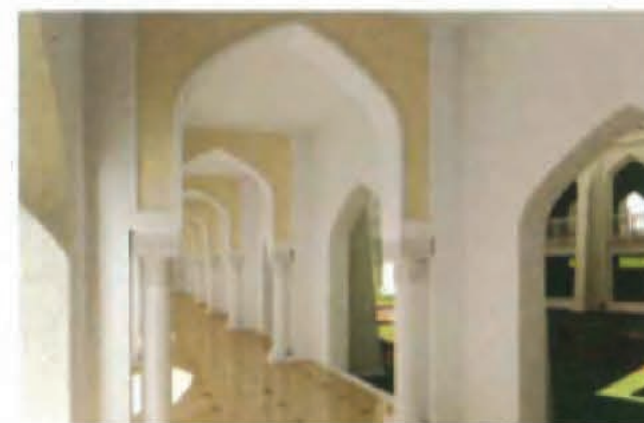

ISTANA ALAM SHAH - MASJID ISTANA DI RAJA



ISTANA ANAK BUKIT, KEDAH



ISTANA NEGARA



Commercial Project



UITM, Puncak Alam



Segi College, Subang Jaya



Sunway Resort Hotel



Eco Majestic Bridge, Semenyih



USJ 19 Condominium, Subang Jaya



The Ritz Carlton, Kuala Lumpur



Menara OCBC, Kuala Lumpur



Tiara Beach Resort, Port Dickson



Penchala Link Tunnel, Mont Kiara



Polis Station Headquarter, Taiping



Nilai Spring Resort Hotel



ARKIB Negara, Kuala Lumpur



Shop lot at Bukit Hitam, Puchong



Puspanita, Putrajaya



Johor Premium Outlet

The first Premium Outlet in Malaysia applied to Precast LRC architectural products – VCC Technology in comprises of Green Technologies efficiency and innovative installation method. Individual outlets designed towards Green and Environmental friendly which proven on cost saving and quality assurance to receive Genting Group project testimony appreciation.



Sayong Bridge, Kuala Kangsar



Palace of the golden Horses Hotel



Mahkamah kubu Bahru



Bukit Tinggi Resort Hotel



Sunway Pyramid Shopping Mall



Diplomatic Engrave Shophouse, Precinct 15 Putrajaya



**PRINCE OF WALES ISLAND
INTERNATIONAL SCHOOL**

ROYALE CHULAN HOTEL, KUALA LUMPUR

A homogeneous precast GRC Panel design that could turn concrete into many forms and design in 2009 for the Malay architecture elements of traditionally inspired hotel in Kuala Lumpur — complete with high-pitched tiled roofs, an expansive courtyard, and rich heritage motifs.



KEMAMAN BRIDGE, TERENGGANU



TANJONG PAGAR RAILWAY STATION AT ISTANA ALAM SHAH, SELANGOR

A pencil with paper, A camera with measurement tape, An architect sense of First Façade project completed that represent Federated Malay State Railway can be replica onto Selangor palace.

The station was stop operation on 30 June 2011. by Keretapi Tanah Melayu (KTM).

The emblem, "Bunga Tanjung" floral panel cladding and Four "Statues" by represents the Malayan and Singapore economy – Agriculture, Commerce, Transport and Industry have prolong the historical value in Malaysia.



Residence Project



Tiara Residence, Kajang



Dato Residence, Bukit Duta



Bungalow Unit U-thant, Kuala Lumpur



Bungalow Unit U-thant, Kuala Lumpur



Dato Residence, Section 7, Shah Alam



Dato Residence, Section 7, Shah Alam



Dato Residence, Taman Yari



Datin Residence, Section 7, Shah Alam



Dato Residence, Bukit Damansara



Dato Residence, Bukit Damansara



Dato Residence, Bukit Damansara



Datin Residence, Section 7, Shah Alam



Tan Sri Residence, Seputeh Height



Dato Residence, Bukit Duta



Dato Residence, Bandar Kinrara



Dato Residence, The Mines



Dato Residence, The Mines

AMPANG RESIDENCE



SECTION 7 SHAH ALAM RESIDENCE



IBS Wall Solution Project



Sprintz Hotel, Seri Petaling



THE ROYAL Flush Restaurant, Ara Damansara



Palace Of Golden Horses Hotel



Tiara Imperio Show Gallery, Bangi



KPKT Apartment, Jinjang



SP Setia Hq Setia Alam



Pkt Warehouse, Kesas Shah Alam



Toyota Showroom, K. Selangor

On-Going Project

SENTRAL SUITES, BRICKFIELD



BUNGALOW TMN SENTOSA, MELAKA



GAIA RESIDENCY, GAMUDA GARDEN SERAI, RAWANG



PANGSAPURI ARANDA, KOTA KEMUNING



4

Project List

2022 – 2016 : Completed Projects

NO	PROJECT NAME	CLIENT	ARCHITECT	CONTRACTOR
	COMPLETED PROJECT			
1	Sentral Suite@ KL Sentral, Kuala Lumpur	Country Annexe Sdn Bhd	Efish Sdn Bhd	MRCB Builders Sdn Bhd
2	Durian Café, Setapak, Kuala Lumpur	Great Fruit Station Sdn Bhd	Moose Garden-Interior Design & Build	CSL Technologies (M) Sdn Bhd
3	Bungalow 3 Storey, Taman Sentosa, Melaka	-	Design International Architects LLP	Ting Eng Kim Construction Sdn Bhd
4	LPHS Pangsapuri Danau Ria, Gamuda Gardens, Rawang	Bandar Serai Development Sdn Bhd	ARC Partnership Sdn Bhd	Gamuda Engineering Sdn Bhd
5	LPHS Pangsapuri Aranda, Kota Kemuning	HICOM Gamuda Development Sdn Bhd	Arcalliance Sdn Bhd	Gamuda Engineering Sdn Bhd
6	ACE Bank Negara, Kuala Lumpur	ACE Holding Berhad	-	Conspec Builders (M) Sdn Bhd
7	Parcel F, Presint 1, Putrajaya	Putrajaya Bina Sdn Bhd	Pakatan Reka Architect Sdn Bhd	Sunway Construction Sdn Bhd
8	Perumahan Penjawat Awam 1 Malaysia – Ketumbar, Presint 17, Putrajaya	Putrajaya Homes Sdn Bhd	Neufornation Architects Sdn Bhd	Pembinaan Mitrajaya Sdn Bhd
9	Starbucks, Tanjung Dua Belas, Selangor	Gamuda Land (T12) Sdn Bhd	Gamuda Industrial Building System	Lim Ho Seng Construction Sdn Bhd
10	Laksmi Villa, Damansara Height	-	MADE Architects	Beckwell Resources Sdn Bhd
11	Sungai Besi Ulu Kelang, Expressway (Suke)	Projek Lintasan Kota Holdings Sdn Bhd (Prolintas)	-	China Communications Construction Company (M) Sdn Bhd
12	GAIA Residences – Serviced Residence, Gamuda Gardens Serai, Rawang	Bandar Serai Development Sdn Bhd	Garis Architects Sdn Bhd	Gamuda Engineering Sdn Bhd
13	Wangsa 9, Residency Condominium, Wangsa Maju	Kina-Bijak Sdn Bhd	SA Architect Sdn Bhd	Mitrajaya Homes Sdn Bhd
14	Residensi SIGC, Paroi Jaya, Negeri Sembilan	Matrix Concepts Holdings Berhad	-	Juwasan Maju Sdn Bhd
15	SJK (C) No.1, Kampung Baru Parit Tinggi, Negeri Sembilan	-	-	Matrix Excel Construction Sdn Bhd
16	Permas Centro 99 unit shop office, Plentong, Johor Bahru	Gabungan AQRS Berhad	-	Gabungan Strategik Sdn Bhd

NO	PROJECT NAME	CLIENT	ARCHITECT	CONTRACTOR
17	One Central Park Condominiums, Desa Park City	Perdana ParkCity	MJ Kanny Architect	Grand Dynamic Builders Sdn Bhd
18	Kem Pasukan Gerakan Am (PGA) Batalion, Simpang Renggam, Johor	Ministry of Finance	-	Suria Synergy Construction Sdn Bhd
19	River of Life (ROL), Kuala Lumpur	Kuala Lumpur City Hall	AECOM	Ekoriver Construction Sdn Bhd
20	Genting Highlands Premium Outlets, Genting Highlands	Genting Highlands Premium Outlets S/B	AIB Architect	MEACS Construction Sdn Bhd

2015 – 2000 : Completed Projects

NO	PROJECT NAME	CLIENT	ARCHITECT	CONTRACTOR
	COMPLETED PROJECT			
1	DUKE Phase 2, Sri Damansara to Tun Razak Link	Ekovest Berhad	-	Besteel Engtech Sdn Bhd
2	Plaza Arcadia, Desa Park City	Putra Perdana Berhad	Arkitekt MAA Sendirian Behad	Putra Perdana Construction Sdn Bhd
3	112 unit Double Storey House, Kajang Perdana	D-Hill Sdn Bhd	Ar C.S Lew	Bima rezeki Sdn Bhd
4	Seremban Double Storey House, Seremban	Juwasan Maju Sdn Bhd	-	Matrix Excel Construction Sdn Bhd
5	Ken Rimba Condominum, Sungai Rasau	Ken Holdings Berhad	K.H.Tan Architect	SNA Consult Sdn Bhd
6	SOHO at Kota Bayuemas, Klang	Sazean Development Sdn Bhd	Lembaga Arkitek Malaysia	GFRC (M) Sdn Bhd
7	Matrix Global School, Seremban	Menteri Besar Negeri Sembilan	KW Assciate Architects Sdn Bhd	GFRC (M) Sdn Bhd
8	Riana Green, Kota Damansara	Riana Green Joint Managaement Body	Henry Butcher	
9	Bungalow at Monterez Golf and Country Club Sec U9, Shah Alam	Mr Tiong & Ms Tok	-	Raintree Building Construction (M) S/B
10	Mix Development at Hattern City, Melaka	Engtex Emerald Sdn Bhd	Gamal Arkitek Perunding (M) S/B	GFRC (M) Sdn Bhd
11	Eco Majestic Pillar, Daerah Ulu Langat, Selangor	Eco Majestic Sdn Bhd	-	Pembinaan Jemerlang Sdn Bhd
12	Bungalow at Country Height, Kajang	Mrs. Manny	Ar. Tan Soon Chai	Han Chung Construction Sdn Bhd
13	Semi-D at Kajang Prima, Kajang	Ekovest Berhad	-	Bima Rezeki Sdn Bhd
14	Energy Sub Station, Mambong, Bintulu, Sarawak	Sarawak Energy Berhad	-	Pestech Sdn Bhd
15	Energy Sub Station, Sakura, Bintulu, Sarawak	METIX Malaysia Sdn Bhd	-	Pestech Sdn Bhd
16	Tiara Imperio, Bangi	Kueen Lai Properties Sdn Bhd	Ar Kuek Wee Chien	Perkasa Tinggi Sdn Bhd
17	Johor Premium Outlets, Kulaijaya Johor - Phase 1, 2 & 3	Genting Simon Sdn Bhd	Bernard Low Architect	Santarli Sdn Bhd
18	SOHO at Kinrara Uptown	Sazean Development Sdn Bhd	-	Motibina Sdn Bhd
19	KPKT Apartment, Jinjang K.L.	Kementerian Perumahan Kerajaan	Jabatan Kerja Raya	Melati Ehsan Holdings Berhad

NO	PROJECT NAME	CLIENT	ARCHITECT	CONTRACTOR
20	Shop Lot at Bachang, Melaka	Projek Impianan Sdn Bhd	RDC Arkitek Sdn Bhd	Infraprima Construction Sdn Bhd
21	Perodua Factory at Sungai Choh, Rawang	Perusahaan Otomobil Kedua Sdn Bhd	-	Legna Construction Sdn Bhd
22	Semi-Detached Factory at Nilai	-	-	Axventure Sdn Bhd
23	Kontiki Restaurant at Federal Hotel, K.L.	-	-	DB & B Design Sdn Bhd
24	Office Block at Kota Iskandar, Bandar Nusajaya, Johor Bahru	UEM Builders Group	-	UEM Construction Sdn Bhd
25	Masjid Noor Hidayah, Felda Sg. Tenggi, Hulu Selangor	Kasad Murni (M) Sdn Bhd	-	Kasad Murni (M) Sdn Bhd
26	Kuantan Medical Centre, Kuantan, Pahang	GFRC Facade (M) Sdn Bhd	Lembaga Arkitel (M) Sdn Bhd	VST Cemerlang Sdn Bhd
27	SP Setia Sky 88 at Setia Alam, Shah Alam	SP Setia HQ	Amir Zulkiflie Sdn Bhd	Santarli Sdn Bhd
28	Town House At Tropicana Golf Resort, Damahsara	Hicom Builders Sdn Bhd	Jazlan Azmi Architects	Hicom Builders Sdn Bhd
29	Institusi Swasta Building at Cycberjaya, Dengkil	Axisjaya Sdn Bhd	HMSK Architecture Sdn Bhd	Axisjaya Sdn Bhd
30	Double Storey House at Dengkil Sepang	Goh Kim Sing Conctruction Sdn Bhd	Mohd Riza	Goh Kim Sing Conctruction Sdn Bhd
31	Banglow House at Jalan Semarak Kesumba	Mr Kumarasen	DCDA Architect	KSPC (M) Sdn Bhd
32	Tanjong Pagar Railway Station Façade, Istana Alam Shah, Klang.	JKR Selangor	CSL Design & Built.	Warisan FMSR
33	Istana Negara Jalan Duta, Kuala Lumpur	Jabatan Kerja Raya Malaysia	Akitek Reka Bina	Maya Maju Sdn Bhd
34	Bungalow Unit At Green Meadow, Seksyen 13, Shah Alam, Selangor	Dato Residence	-	Ultimate Builders Sdn Bhd
35	Bungalow unit At Jalan Mengkuang, Ampang, Kuala Lumpur	Puan Sri Residence	Architect Sahlan	Formscape Sdn Bhd
36	Ken Rimba Legian, 328 Units Terrace House, Sec. 16, Shah Alam, Selangor	Ken Holding Sdn Bhd	-	Ken Grouting Sdn Bhd
37	Bungalow Unit Seksyen 7, 40000, Shah Alam, Selangor	Dato's Residence	Akitek Khalid	Fernline Construction Sdn Bhd
38	Johore Premium Outlet (JPO) Kulaijaya, Johor - Phase1	Genting Simon Sdn Bhd	Benard Low Architect	Santarli Sdn Bhd
39	Government Office Building At Lot 5G2 & 5PL1, Precinct 5, Putrajaya	Putrajaya Holding Berhad	-	Bina Goodyear Sdn Bhd

NO	PROJECT NAME	CLIENT	ARCHITECT	CONTRACTOR
40	Ibu Pejabat Polis Daerah Taiping : Bandar Taiping, Perak	Polis Di Raja Malaysia	Perkhidmatan Akitek	Punchak Matrik Sdn Bhd
41	Ibu Pejabat Felda Seksyen 63, Jalan Stonor, Kuala Lumpur	NAZA TTDI	-	Putra Perdana Const. Sdn Bhd
42	3 Storey Bungalow Unit At Section 7, Shah Alam, Selangor.	Dato's Residence	SK TAN Architect	
43	MTJ International School, Balik Pulau, Penang	MTJ Development Sdn Bhd.	Akitek AO	Daya CMT Sdn Bhd
44	Institute Kemahiran Belia Negara (IKBN) Kuala Langat, Selangor	Jabatan Kerja Raya Malaysia.	Gabungan Strategik Sdn Bhd	Gabungan Strategik Sdn Bhd
45	Istana Selangor (Klang) Masjid, Klang	Sultan Selangor	Akitek Reka Bina	Kosmo Setegas Sdn Bhd
46	Masjid Minerat, UTM Shah Alam, Selangor.	UTM Shah Alam	Azza Associate Architects	Lincha Development Sdn. Bhd.
47	Lot Pt 453, Jalan Kerjaya, Seksyen U1, 40150 Shah Alam, Selangor	Jabatan Kerja Raya Malaysia.	-	Chop Eng Hup Heng Sdn Bhd
48	1000 Units Villa (Mock-Up) Unit At Dubai	Deva Development Public Co. Ltd.	Deva Design & Consult Co.	Deva Development Public Co. Ltd.
49	Irat Hotel At Raja Chulan, Kuala Lumpur	Boustead Holding Berhad	Design & Consultant	Infra Segi Construction Sdn Bhd
50	1 Units Villa project "Villa Bonavita" At Italy.	Mr Alberto Bassi	Dacia S.R.L.	Alea S.R.L.
51	Development of Iraqi Embassy at Diplomatic Enclave, Putrajaya.	IRAQI EMBASSY	-	Seroja Yakin (M) Sdn Bhd
52	3 Storey Bungalow Unit At Mines Country Resort, Kuala Lumpur.	Dato's Residence	BTA Architect	Wijaya Bina Sdn. Bhd.
53	ARKIB Negara, Pahang Branch, Kuantan, Pahang	Jabatan Kerja Raya Malaysia.	Jabatan Kerja Raya Malaysia.	Saujana Anggerik Sdn Bhd
54	18 Storey Condominium At Cova Square, Kota Damansara, Selangor.	Pharma Exel Sdn Bhd	Veritas Arch Sdn Bhd	Mahasalam Sdn Bhd
55	Nilai Spring Hotel At Nilai, Negeri Sembilan	Nilai Spring Hotel	Alan Lok Design & Consultant S/B	Quick Series Sdn. Bhd
56	Campus University Technology Mara At Puncak Alam, Selangor..	TRI plc Berhad	GDP Architech Sdn Bhd	Mahasalam Sdn Bhd
57	21 Storey Condominium, Block D, Rhythm Avenue, USJ 19, Subang Jaya, Selangor.	Arab Malaysia Band Berhad	Perkhidmatan Akitek	SM-Mahasalam Land Sdn Bhd
58	Istana Kedah Complex , Anak Bukit, Alor Setar, Kedah Darul Aman.	Kerajaan Negeri Kedah	Azza Associate Architects	Darulaman Builder Sdn Bhd
59	See Hoy Chai Building At Jalan Sultan, Kuala Lumpur	See Hoy Chan Properties Sdn Bhd	-	Dyno Best Sdn Bhd

NO	PROJECT NAME	CLIENT	ARCHITECT	CONTRACTOR
60	63 Units Bungalow & Semi-Detached At Tiara Residence, Kajang.	IKueen Lai Properties Sdn Bhd	Perkhidmatan Akitek	Perkasa Tinggi Sdn Bhd
61	1 Units Villa project "Villa Franca" At Italy.	Mr Alberto Bassi	Dacia S.R.L.	Dacia S.R.L.
62	43 Units IBS School (Blok Tambahan) At Klang Valley.	Jabatan Kerja Raya Malaysia.	Jabatan Kerja Raya Malaysia.	Gabungan Strategik Sdn Bhd
63	8 Units Bungalow At Genting Tiara, Genting Sempah, Pahang	Oil Corp Berhad	Oil Corp Builder & Management S/B	Genesis Acres Sdn Bhd
64	Double Storey Shop lot I At Bandar Puchong, Selangor.	Bukit Hitam Development Sdn Bhd	Bukit Hitam Consultant Sdn Bhd	Cendana Maju Construction S/B
65	Sunway Pyramid Shopping Mall At Bandar Sunway, Petaling Jaya, Selangor.	Sunway Pyramid Sdn Bhd	Sunway Design Sdn Bhd	Sunway Pyramid Sdn Bhd
66	3 Storey Bungalow Unit At Lot 193 & 196 Jalan U-Thant 1, Kuala Lumpur.	Dato's Residence	A&A Architech Sdn Bhd	Arat Semarak Sdn Bhd
67	Wisma Darulaman, Alor Setar, Kedah Darul Aman.	Kerajaan Negeri Kedah	Azza Associate Architects	GFRC (M) Sdn Bhd
68	Sunway Pyramid Shopping Mall Phase 2, Bahdar Sunway, Petaling Jaya, Selangor.	Sunway City Berhad	Sunway Design Sdn Bhd	Sunway Construction Sdn Bhd
69	724 Units 3 And 4 Storey Apartment At Section 11, Kota Damansara, Selangor.	(PKNS)	Perkhidmatan Akitek Sdn. Bhd.	Pembinaan Anggerik Sdn. Bhd
70	KY'S Residence Viilla Duta, Jalan Changkat Duta, Bukit Duta, Kuala Lumpur.	Mr. Chia Kar Yih	Kee Architect	Anjūr Khas Sdn Bhd
71	180 Units Condominium 1 At Jalan Raja-Abdullah, Kuala Lumpur.	Capital Square Sdn Bhd	GDP Architect Sdn. Bhd.	GFRC (M) Sdn Bhd
72	Taman Rekreasi Pudu Ulu (Fasa 1) At Wilayah Persekutuan.	Dewan Bandaraya Kuala Lumpur (DBKL)	Mouphosis Design Sdn. Bhd.	Pisonia Landscaping Sdn. Bhd.
73	724 Units 3 And 4 Storey Apartment At Section 11, Kota Damansara, Selangor.	(PKNS)	Perkhidmatan Akitek	Legrand Corporation Sdn Bhd
74	Pembangunan Perumahan Anggota Tentera & Kakitangan Awam (Kem Pasifik) Di Atas Lot 1812 & Lot 983 Mukim Ampang, Kuala Lumpur.	Jabatan Kerja Raya (JKR)	Gabungan Strategik Sdn. Bhd.	Pembinaan Megah Ikhlas Sdn Bhd
75	Government Residential At Jalan 1/76, (U-Thant 1)-Jalan Desa Pandan, KL.	Government Residential		Perwira Bintang Holding Sdn. Bhd
76	Office Block At Kompleks Kerajaan Daerah Tanah, Banting, Kuala Langat.	(PKNS)	Akitek MAA Sdn. Bhd.	Imaprima Sdn Bhd
77	131 Unit Shop Houses Diplomatic Enclave, Precinct 15, Putrajaya.	Putrajaya Holding Sdn. Bhd.(PJH)	Putrajaya Holding Sdn. Bhd.(PJH)	Sunway Construction Berhad
78	The First World Hotel, Convention Hall At Genting Highland.	Resort World Berhad	Genting Word Architect Sdn. Bhd.	C.S Alloy Design(M) Sdn Bhd

NO	PROJECT NAME	CLIENT	ARCHITECT	CONTRACTOR
79	Bungalow Unit At Taman Seputih Height, Kuala Lumpur.	Tan Sri Residence	Akitek Daya Reka	GFRC (M) Sdn Bhd
80	Bungalow Unit At No.7, Jalan U-Thant 1, Seksyen 89A, Bandar Kuala Lumpur.	Dato's Residence	Neu-Formation Architect	Perspective Const.& Interior S/B
81	Tiara Beach Resort & Club House At Port Dickson, Negeri Sembilan.	Ascentland Sdn Bhd	CSP Architect	Ascentland Sdn Bhd
82	Tiara Beach Resort & Club House At Port Dickson, Negeri Sembilan.	Ascentland Sdn Bhd	Peter Pan Associates Sdn. Bhd.	Ascentland Sdn Bhd
83	Bungalow Unit At Jalan Setia Murni 6, Damansara Height, Kuala Lumpur	Dato's Residence	Gabungan Arkitek Sdn. Bhd.	DB Consolidated Sdn. Bhd
84	Kampung International Restaurant In Genting Hotel, Genting Highland.	Resort World Berhad	Exis Network Design Sdn. Bhd.	World Built Sdn. Bhd
85	12 Storey At Lot P.T. 1220 Segi College, USJ Subang, Petaling Jaya.	Shaw Commercial Institution Sdn Bhd	SN Low Associate Sdn. Bhd.	GFRC (M) Sdn. Bhd
86	209 Units Double Storey Medium Cost At Putra Perdana, Selangor.	Lestari Puchong Sdn Bhd	-	Salam Kurnia Sdn Bhd
87	Bangi Walk At Taman Bandar, Pusat Bandar Baru Bangi, Selangor	(PKNS)	Perbadanan Kemajuan Negeri Selangor	Top Bowl Enterprise
88	10 Storey 100 Units Low Cost And 196 Unit Low Medium Cost Apart. Kajang.	Sunway City Berhad	-	Sunway Construction Berhad
89	Kayangan Road Side Enhancement At Majlis Perbandaran Shah Alam.	Majlis Bandaraya Shah Alam (MBSA)	Majlis Bandaraya Shah Alam (MBSA)	Treemaster Sdn. Bhd
90	Western Traffic Dispersal Scheme Tunnel At Penchala Link, Kuala Lumpur.	Lembaga Lebuhraya Malaysia (LLM)	Arkitek M & L Sdn. Bhd.	Gamuda Engineering Sdn. Bhd
91	Istana Perlis Istana Arau, DYMM Raja Perlis.	Jabatan Kerja Raya (JKR), Perlis	Arra Architects Planners Designers	Jetson Construction Sdn Bhd
92	6th Storey Bangunan Dewan India Temple At Jalan Hang Kasturi, Kuala Lumpur.	India Association Kuala Lumpur	Arkitek Perunding RDA	Kosmo Setegas Sdn. Bhd
93	20 Storey Office Of OCBC Bank Property At Jalan Tun Perak, Kuala Lumpur	OCBC Bank (Malaysia) Berhad	Arkitek MAA Sdn. Bhd.	Ireka Engineering & Const. S/B
94	Rumah Puspanita Kebangsaan Kerajaan Building At Precinct 10, Putrajaya.	Putrajaya Holding Sdn. Bhd. (PJH)	Putrajaya Holding Sdn. Bhd. (PJH)	Putra Perdana Const. Sdn Bhd
95	Bungalow Unit At Bukit Damansara, Kuala Lumpur	Dato's Residence	Linea Architect Sdn Bhd	Linea Architect Sdn Bhd
96	New Smart School Phase 2 At Precinct 8, Putrajaya.	Putrajaya Holding Sdn. Bhd. (PJH)	Putrajaya Holding Sdn.Bhd. (PJH)	Crest Builder Sdn Bhd
97	Street Landscape Work "Shah Alam Walk" At Shah Alam, Selangor.	Majlis Bandaraya Shah Alam (MBSA)	Landscape Greenville Sdn Bhd.	Field-Lawn Master Sdn. Bhd
98	Majlis Bandaraya Shah Alam, Persiaran Sultan, Shah Alam Selangor.	Majlis Bandaraya Shah Alam (MBSA)	Landscape Greenville Sdn Bhd.	Mecel Engineering Sdn Bhd

NO	PROJECT NAME	CLIENT	ARCHITECT	CONTRACTOR
99	Proposed Four Storey Mahkamah Baru, Selayang.	IMajlis Perbandaran Selayang. (MPS)	Jabatan Kerja Raya (JKR)	Jasaman Sendirian Berhad
100	Istana Darul Eshan At Precinct 6, Putrajaya.	Putrajaya Holding Sdn. Bhd.(PJH)	Konsultant Kumpulan Seni Reka S/B	Target Resources Sdn. Bhd
101	3.5 Km Long Street Landscape Display Boulevard , Precinct 2, Putrajaya.	Putrajaya Holding Sdn. Bhd.(PJH)	Hijias Kasturi-Association Sdn. Bhd.	Hasrat Usaha Sdn. Bhd
102	Istana Perak New Gallery At Istana Hulu, Sultan Perak Darul Ridzuan.	Jabatan Kerja Raya (JKR)	Jabatan Kerjaraya Ipoh (JKR)	Pantel Enterprises Sdn. Bhd
103	Five & Eleven Storey Height Medium Low Cost Apartments At Klang, Selangor.	Majlis Perbandaran Klang.(MPK)	Jabatan Kerja Raya	Cendana Maju Sdn. Bhd
104	Bungalow Unit AT Glenmarie Court, Shah Alam, Selangor Darul Ehsan.	Dato's Residence	Juruhiasan Consult Sdn Bhd	Homewest Sdn.Bhd
105	New Bridge Kuala Kangsar Sayong, Kuala Kangsar, Perak Darul Ridzuan	Jabatan Kerja Raya (JKR)	Jabatan Kerja Raya Ipoh (JKR)	Latimer Corporation Sdn. Bhd
106	3 Blocks 33th Storey Apartments At UEP Subang Jaya, Selangor.	(PKNS)	-	Tong Chun Landscaping Sdn. Bhd
107	French Castle & Hotel, Colmar Village, Bukit Tinggi, Pahang	Berjaya Group Berhad	-	Lux Bee Enterprise Sdn. Bhd
108	Grand Ballroom & Foyer At The First World Hotel Genting Highlands, Pahang.	Resort World Berhad	Ho Wah Design Sdn. Bhd.	Ho Wah Interior Deco Sdn. Bhd
109	French Castle & Hotel, Colmar Village, Bukit Tinggi, Pahang	Berjaya Group Berhad	-	IJM Construction Sdn. Bhd

Contact Us



Main Office & Factory :

CSL TECHNOLOGIES (M) SDN BHD (429166-A)

Lot 7705, Batu 11 3/4, Jalan Kuari Sungai Long,
43100 Hulu Langat,
Selangor Darul Ehsan,
Malaysia.

Tel : 012-657 0113 (Office H/P)
012-268 6986 (Hermen Tan)

Email : lrcinside@lrc.com.my
marketing@lrc.com.my

WWW.LRC.COM.MY

 www.facebook.com/lrcinside
 www.youtube.com/watch?v=89kgqrMc0hY

WWW.LRC.COM.MY

